



5 Limetrees Close

Port Clarence, Middlesbrough, TS2 1SL

Offers in excess of £50,000



For Sale With The Advantage Of No Onward Chain & Vacant Possession! An Affordable Purchase & Excellent Investment Opportunity - Ready To Go!

Harper & Co Estate Agents Offer Flexible Viewing Appointments Including Evening & Weekends! You Can Call, Text, WhatsApp Message Or Email Us To Secure Your Booking. Get in Touch Today!



Location:

Located In Port Clarence, From The A1047 (Port Clarence Road), Take A Turn Onto Lime Tree Close & The Property Is Located On The Left-Hand Side.

Local Amenities Include;

High Clarence Primary School - 9 Minute Walk

Convenience Store & Post Office - 8 Minute Walk

Journey Times Estimated Using Google Maps.

Entrance Hallway

Lounge

16'1" x 12'7" (4.91m x 3.86m)

Electric Fire Place With Surround, Under Stairs Storage Cupboard, uPVC Double Glazed Window, Door Leading To Kitchen.

Kitchen

12'5" x 10'4" (3.80m x 3.16m)

Fitted With Wooden Base, Wall & Drawer Units, Tiled Backsplash, Wooden Work Surfaces Incorporating An Electric Hob & Stainless Steel Sink Unit, Electric Oven & Overhead Extractor Fan, Space For A Washing Machine & Fridge Freezer, Space For Dining Table & Chairs, Door Leading To Rear Garden.

First Floor Landing

Providing Access To Both Bedrooms & Bathroom, Storage Cupboard.

Bedroom One

12'7" x 11'3" (3.85 x 3.44)

Spacious Bedroom With Radiator & uPVC Double Glazed Windows.

Bedroom Two

10'7" x 9'8" (3.23 x 2.96)

Radiator & uPVC Double Glazed Windows, Storage Cupboard.

Bathroom

6'3" x 6'0" (1.93 x 1.85)

Part Tiled Bathroom With Hand Wash Basin, Bath With Overhead Electric Shower & W/C.

Energy Efficiency Rating; F

Since Purchase, The Vendor Informs Us They Have Had A New Gas Combi Boiler & Central Heating System Installed. Along With Loft & Cavity Wall Insulation. The Full Energy Efficiency Certificate Is Available On Request.

Council Tax Band: A

Disclaimer

Measurements Are Approximate & To The Widest Point. The Floor Plan Is Not To Scale And For Illustrative Purpose Only.

Area Map



Floor Plans

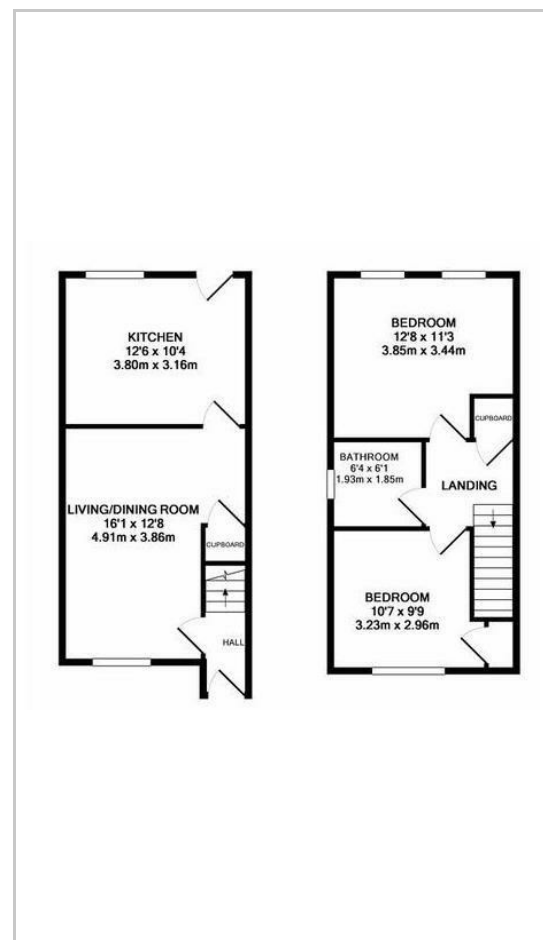

Energy Efficiency Graph

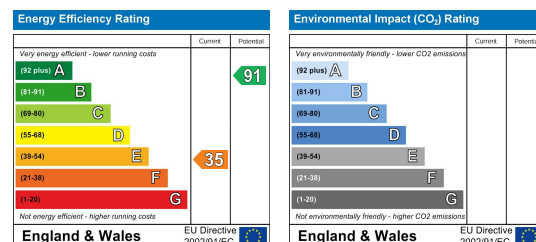

These particulars, whilst believed to be accurate are set out as a general outline only for guidance and do not constitute any part of an offer or contract. Intending purchasers should not rely on them as statements of representation of fact, but must satisfy themselves by inspection or otherwise as to their accuracy. No person in this firm's employment has the authority to make or give any representation or warranty in respect of the property.